

Order Information

HeartR™ Membranous VSD (Symmetric) Occluder

Code	D Waist Diameter (mm)	D1 Right Disc Diameter (mm)	D2 Left Disc Diameter (mm)	L Waist Length (mm)	Minimum Recommended Sheath Size SteerEase™ (Fr.)
XJFVM04	4	8	8	3	SFP5F
XJFVM05	5	9	9	3	SFP5F
XJFVM06	6	10	10	3	SFP6F
XJFVM07	7	11	11	3	SFP6F
XJFVM08	8	12	12	3	SFP7F
XJFVM10	10	14	14	3	SFP7F
XJFVM12	12	16	16	3	SFP9F
XJFVM14	14	19	19	3	SFP9F
XJFVM16	16	21	21	3	SFP9F
XJFVM18	18	23	23	3	SFP10F
XJFVM20	20	25	25	3	SFP10F
XJFVM22	22	27	27	3	SFP12F
XJFVM24	24	29	29	3	SFP12F

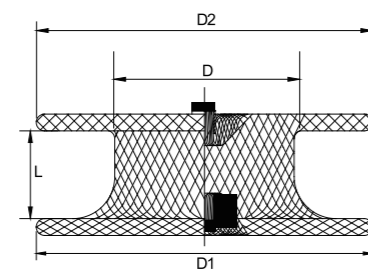

HeartR™ Membranous VSD (Asymmetric) Occluder

Code	D Waist Diameter (mm)	D1 Right Disc Diameter (mm)	D2 Left Disc Diameter (mm)	L Waist Length (mm)	Minimum Recommended Sheath Size SteerEase™ (Fr.)
XJFVM04A	4	9	11.6	3	SFP5F
XJFVM05A	5	10	12.6	3	SFP5F
XJFVM06A	6	11	13.6	3	SFP6F
XJFVM07A	7	12	14.6	3	SFP6F
XJFVM08A	8	13	15.6	3	SFP7F
XJFVM10A	10	15	17.6	3	SFP7F
XJFVM12A	12	17	19.6	3	SFP9F
XJFVM14A	14	19	21.6	3	SFP9F
XJFVM16A	16	21	23.6	3	SFP9F
XJFVM18A	18	23	25.6	3	SFP10F
XJFVM20A	20	25	27.6	3	SFP10F
XJFVM22A	22	27	29.6	3	SFP12F
XJFVM24A	24	29	31.6	3	SFP12F

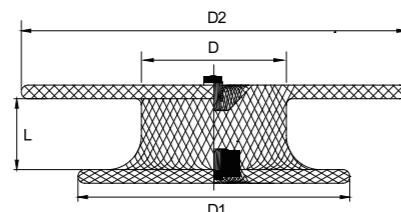

HeartR™ Membranous VSD (Eccentric) Occluder

Code	D Waist Diameter (mm)	D1 Right Disc Diameter (mm)	D2 Left Disc Diameter (mm)	L Waist Length (mm)	Minimum Recommended Sheath Size SteerEase™ (Fr.)
XJFVM04B	4	10	10	3	SFP5F
XJFVM05B	5	11	11	3	SFP5F
XJFVM06B	6	12	12	3	SFP6F
XJFVM07B	7	13	13	3	SFP6F
XJFVM08B	8	14	14	3	SFP7F
XJFVM10B	10	16	16	3	SFP7F
XJFVM12B	12	18	18	3	SFP9F
XJFVM14B	14	20	20	3	SFP9F
XJFVM16B	16	22	22	3	SFP9F
XJFVM18B	18	24	24	3	SFP10F
XJFVM20B	20	26	26	3	SFP10F
XJFVM22B	22	28	28	3	SFP12F
XJFVM24B	24	30	30	3	SFP12F

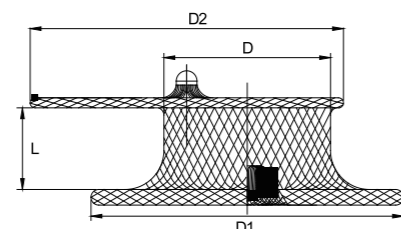

HeartR™ PDA Occluder

Code	D Retention Skirt (mm)	D1 Proximal Diameter (mm)	D2 Distal Diameter (mm)	L Waist Length (mm)	Minimum Recommended Sheath Size SteerEase™ (Fr.)	Maximum Recommended Sheath Size SteerEase™ (Fr.)
XJFD0406	10	4	6	7	SFP5F	SFP6F
XJFD0608	12	6	8	7	SFP6F	SFP7F
XJFD0810	14	8	10	7	SFP7F	SFP7F
XJFD1012	16	10	12	7	SFP8F	SFP8F
XJFD1214	20	12	14	7	SFP8F	SFP9F
XJFD1416	22	14	16	8	SFP8F	SFP9F
XJFD1618	24	16	18	8	SFP9F	SFP10F
XJFD1820	26	18	20	9	SFP10F	SFP12F
XJFD2022	28	20	22	9	SFP12F	SFP12F
XJFD2224	30	22	24	10	SFP12F	SFP14F

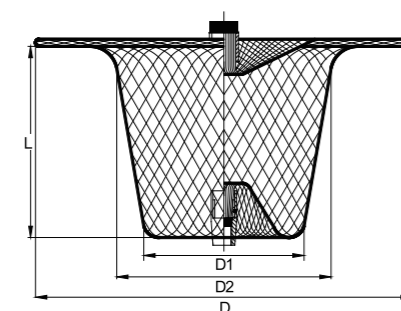

Note: Some products not available in all markets, please check with your local representative for availability.



HeartR™ occluder
Close Defect, Reconstruct Function

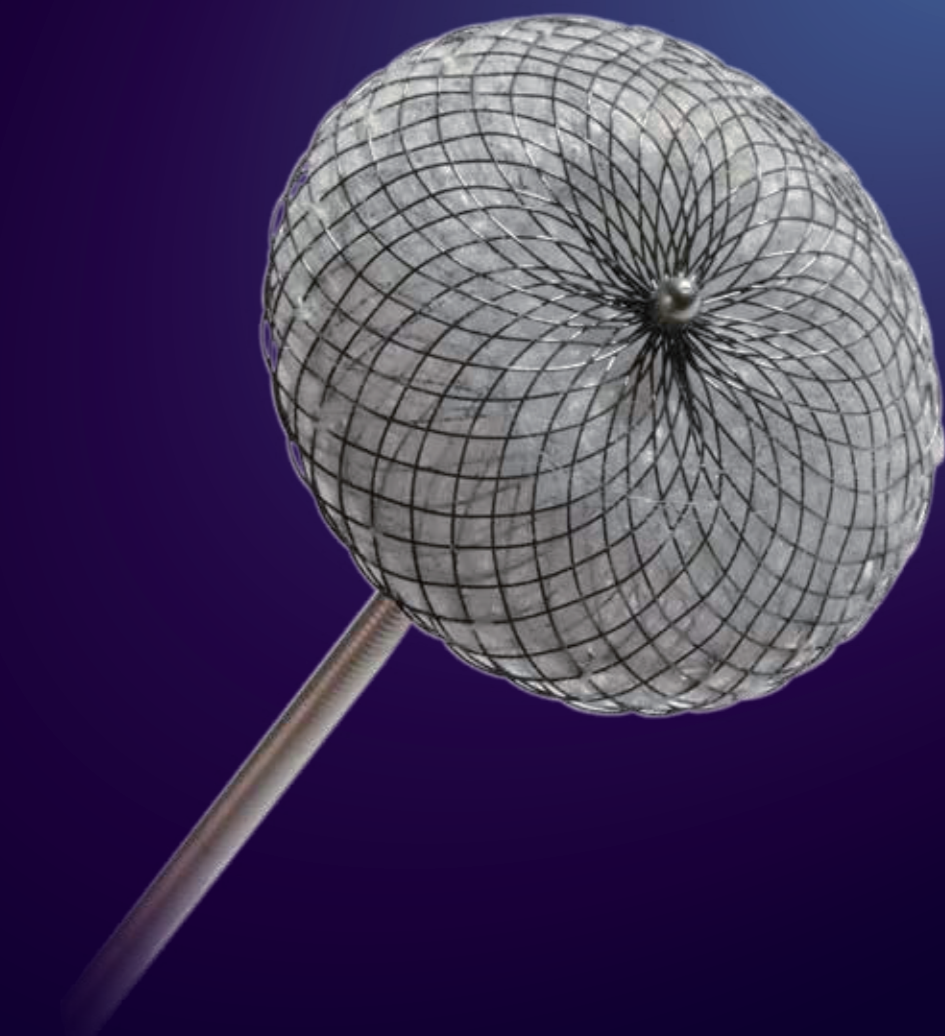

Lifetech Scientific (Shenzhen) Co., Ltd.

Add: 8F, Lifetech Scientific Building, No.22, Keji 12th Road South, High-tech Industrial Park, Yuehai Subdistrict, Nanshan District, Shenzhen 518063, P. R. China.
Tel: +86-755-86026250 Fax: 86-755-86026251
Email: marketing@lifetechmed.com
Web: www.lifetechmed.com

EU authorized representative:
Life Tech Scientific (Europe) Coöperatief U.A
Oliemolenstraat 60, 6416CB Heerlen, the Netherlands
2021-EN-1.0

HeartR™ occluder
Defect Occluder



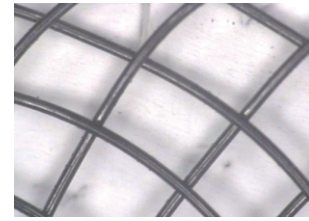

PTFE

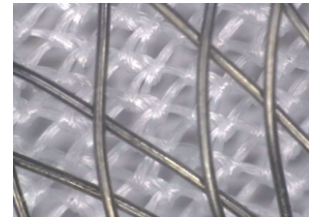

PET

Modified Design

- Self-expandable Double disc occluder made from Nitinol filament weaved struts.
- Shape memory effect and hyperelasticity.
- PTFE membrane is delicately sewn into the VSD/PDA devices decreasing residual shunts and have good biocompatibility.
- PET material sewn into ASD device increases the occlusive properties.

High Rate of Immediate Occluding, Low Rate of Long-term Residual Shunt

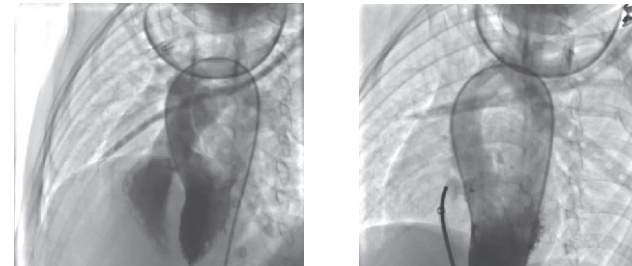

Pre-operation

Post-operation

- Comply with heart anatomy morphology.
- High rate of immediate occluding.
- Much faster and denser of endocardium growth decrease residual shunt.
- Minimize the occluder's stimulation, low incidence of long-term arrhythmia.
- Transcatheter ASD/PDA/VSD closure with the reports over 98% successful occlusion rates at 1,3 and 6 months follow-up with low adverse event risk and no residual shunts were found¹.

¹ Chen Jingwei, Zhangwei, Chen Haisheng. Transcatheter closure of congenital heart defect with homemade occluder : a report of 53 cases[J]. South China Journal of Cardiovascular Diseases, 2005, 11 (6) :421-423.

Compliance with Three-dimensional Anatomy of Heart

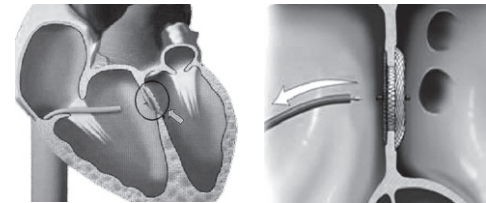

- Modified design parameters: Waist height and Edge.
- Occluder morphology: more suitable for clinical needs, perfect compliance with heart anatomy.
- 3 different types of peri-membranous VSD device.



HeartR™ ASD Occluder



HeartR™ Multi-Fenestrated (Cribriform) ASD Occluder



HeartR™ Muscular VSD Occluder



HeartR™ Membranous VSD (Symmetric) Occluder



HeartR™ Membranous VSD (Asymmetric) Occluder



HeartR™ Membranous VSD (Eccentric) Occluder



HeartR™ PDA Occluder

Order Information

HeartR™ ASD Occluder

Code	D Waist Diameter (mm)	D1 Right Disc Diameter (mm)	D2 Left Disc Diameter (mm)	L Waist Length (mm)	Minimum Recommended Sheath Size SteerEase™ (Fr.)	Minimum Recommended Sheath Size Fustar™ (Fr.)
XJFS06	6	14	18	4	SFA7F	SVA7F-800
XJFS08	8	16	20	4	SFA7F	SVA7F-800
XJFS10	10	18	22	4	SFA7F	SVA7F-800
XJFS12	12	22	26	4	SFA8F	SVA8F-800
XJFS14	14	24	28	4	SFA9F	SVA9F-800
XJFS16	16	26	30	4	SFA9F	SVA9F-800
XJFS18	18	28	32	4	SFA9F	SVA9F-800
XJFS20	20	30	34	4	SFA10F	SVA10F-800
XJFS22	22	32	36	4	SFA10F	SVA10F-800
XJFS24	24	34	38	4	SFA12F	SVB12F-800
XJFS26	26	36	40	4	SFA12F	SVB12F-800
XJFS28	28	38	42	4	SFA12F	SVB12F-800
XJFS30	30	40	44	4	SFA12F	SVB12F-800
XJFS32	32	42	46	4	SFA12F	SVB12F-800
XJFS34	34	44	50	4	SFA14F	SVB14F-800
XJFS36	36	46	52	4	SFA14F	SVB14F-800
XJFS38	38	48	54	4	SFA14F	SVB14F-800
XJFS40	40	50	56	4	SFA14F	SVB14F-800
XJFS42	42	52	58	4	SFA14F	SVB14F-800

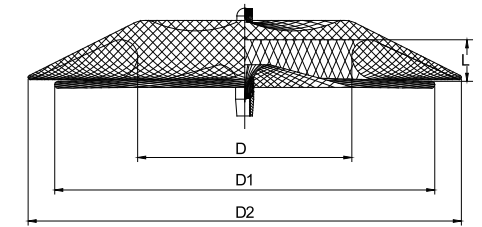

HeartR™ Multi-Fenestrated (Cribriform) ASD Occluder

Code	D1 Right Disc Diameter (mm)	D2 Left Disc Diameter (mm)	L Waist Length (mm)	Minimum Recommended Sheath Size SteerEase™ (Fr.)
XJFS1818	18	18	3	SFA8F
XJFS2518	25	18	3	SFA9F
XJFS2525	25	25	3	SFA9F
XJFS3030	30	30	3	SFA10F
XJFS3525	35	25	3	SFA12F
XJFS3535	35	35	3	SFA12F
XJFS4040	40	40	3	SFA12F

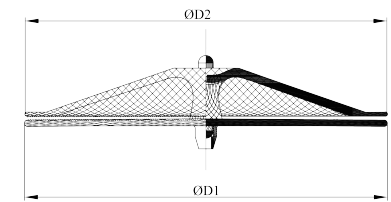

HeartR™ Muscular VSD Occluder

Code	D Waist Diameter (mm)	D1 Right Disc Diameter (mm)	D2 Left Disc Diameter (mm)	L Waist Length (mm)	Minimum Recommended Sheath Size SteerEase™ (Fr.)
XJFVJ04	4	10	10	7	SFP5F
XJFVJ05	5	11	11	7	SFP5F
XJFVJ06	6	12	12	7	SFP5F
XJFVJ07	7	13	13	7	SFP6F
XJFVJ08	8	14	14	7	SFP7F
XJFVJ10	10	16	16	7	SFP7F
XJFVJ12	12	18	18	7	SFP9F
XJFVJ14	14	20	20	7	SFP9F
XJFVJ16	16	22	22	7	SFP9F
XJFVJ18	18	24	24	7	SFP10F
XJFVJ20	20	26	26	7	SFP10F
XJFVJ22	22	28	28	7	SFP12F
XJFVJ24	24	30	30	7	SFP12F

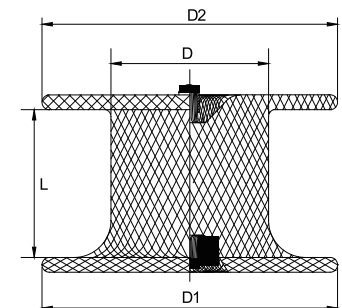

HeartRTM Occluder

Defect Occluder

HeartRTM Occluder

Defect Occluder