

D1

Product & Cartridge Profile

Introduced in 2019 as the first bench top blood gas analyzer in China with its "All-in-One" cartridge system. Great performance has won good reputation domestically and externally.

Product Highlights

All-in-one Cartridge

- No fluidics in instrument, maintenance free
- Self-contained calibration, cleaning solution & biohazard waste collection pack
- Optimized cartridge design minimizes clot formation

Easy Operation

- Touch-screen with intuitive prompts
- Simple 4-step process, easy to use
- Supports HL7 protocol for LIS/HIS



High Efficiency

- Revolutionary microsensor technology, 33 parameters in only 60 seconds
- Automatic calibration and continuous system performance monitoring
- Built in printer, print results automatically after detection

Ultimate Flexibility

- Compact size for various units (ICU, ED, OR, etc.)
- Convenient handle, easy to carry
- Built-in battery, 4 hours back-up

Product Operation

4-step Operation



1. Choose items and click "Start" to take the test.

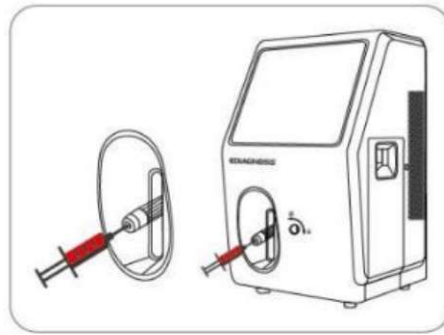

2. Auto aspirate the sample to be tested.



3. Scan or enter patient ID.

The screenshot shows the results screen with a table of test results. The table has columns for 'Parameter', 'Value', 'Unit', and 'Range'. A 'Print' button is visible on the right side.

Parameter	Value	Unit	Range
pH	7.40	-	(7.35 - 7.45)
pCO ₂	45.0	mmHg	(35.00 - 45.00)
pO ₂	147.8	mmHg	(80.0 - 300.0)
K ⁺	3.90	mmol/L	(3.50 - 4.80)
Na ⁺	137.0	mmol/L	(130 - 145)
Ca ²⁺	1.00	mmol/L	(1.00 - 1.25)
Cl ⁻	100.0	mmol/L	(90.0 - 105.0)
Glu	5.0	mmol/L	(3.9 - 5.8)
Hct	40.0	%	(35.0 - 50.0)

4. Wait for 60s and print test results.

Product Specifications



Net weight: **9.5 kg**

Category	Specification
Throughput	Results in 60 Seconds after Sample Aspiration
Sample Volume	150 μ L
Operation Environment	10°C-31°C
Power Supply	AC 100 ~ 240V, 50Hz/60Hz
Dimensions & Net Weight	260*270*410mm, 9.5Kg
Display	10.4-inch color LCD touch screen display, resolution 1024*768
Battery	Lithium-ion battery 14.8v/6500mAh
Accessory	Barcode scanner
Interface	4*USB 2.0 host, WLAN
Storage Capacity	100000+ Tests
Communication Link	Supports HL7 protocol for LIS/HIS

*No fluidics and electrodes inside the analyzer for routine maintenance

Cartridge & Parameters

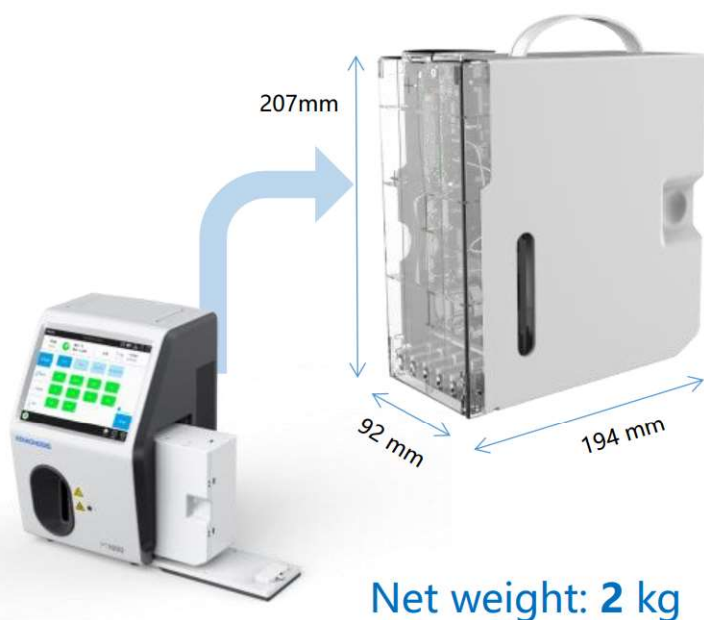

Measurement Parameters (10 items)

Parameter	Unit	Reportable Range	Precision (CV)
pH	-	6.8-8.0	SD≤0.02
pO ₂	mmHg	20-600	CV≤7.5%
pCO ₂	mmHg	15-130	SD≤2.5mmHg
Na ⁺	mmol/L	100-180	CV≤1.5%
K ⁺	mmol/L	2.0-9.0	SD≤0.25mmol/L
Ca ⁺⁺	mmol/L	0.25-2.5	SD≤0.15mmol/L
Cl ⁻	mmol/L	70-150	CV≤5%
Glu	mmol/L	1.1-27	CV≤5%
Lac	mmol/L	0.3-17	CV≤7.5%
Hct	%PCV	20%-70%	CV≤3%

Calculation Parameters (23 items)

cH⁺, cH⁺(T), pH(T), pCO₂(T), pO₂(T), HCO₃⁻-act, HCO₃⁻-std, BB(B), BE(B), BE(ecf), CtCO₂, Ca⁺⁺(7.4), sO₂(est), AnGap, tHb(est), pO₂(A-a), pO₂(A-a) (T), pO₂(a/A), pO₂(a/A) (T), RI, RI(T), pO₂/FIO₂, pO₂(T)/FIO₂

Cartridge Specifications

Category	Model	Analyze Items	Spec.
Cartridges	PT3	pH, pCO ₂ , pO ₂	60 tests/kit 120 tests/kit 200 tests/kit 300 tests/kit
	PT4L	pH, pCO ₂ , pO ₂ , Lac	
	PT4H	pH, pCO ₂ , pO ₂ , Hct	
	PT5	pH, pCO ₂ , pO ₂ , Lac, Hct	
	PT6E	pH, Na ⁺ , K ⁺ , Ca ⁺⁺ , Cl ⁻ , Hct	
	PT6	pH, pCO ₂ , pO ₂ , Glu, Lac, Hct	
	PT8	pH, pCO ₂ , pO ₂ , Na ⁺ , K ⁺ , Ca ⁺⁺ , Cl ⁻ , Hct	
	PT9L	pH, pCO ₂ , pO ₂ , Na ⁺ , K ⁺ , Ca ⁺⁺ , Cl ⁻ , Lac, Hct	
	PT9G	pH, pCO ₂ , pO ₂ , Na ⁺ , K ⁺ , Ca ⁺⁺ , Cl ⁻ , Glu, Hct	
	PT10	pH, pCO ₂ , pO ₂ , Na ⁺ , K ⁺ , Ca ⁺⁺ , Cl ⁻ , Glu, Lac, Hct	

Storage Temperature  15°C~25°C Room temperature storage of consumable

Shelf Life 180 days

Onboard Shelf Life 21 days/14 days

Sample Type Arterial blood, venous blood, capillary blood, quality control

Dimensions 194*92*207mm

Weight 2kg

Calibration One point calibration, two point calibration

Components Calibration solution, rinse solution, sensors, sample probe and waste bag

*No standby consumption, regular syringe sampling to save cost & time

Quality Control

model	Type	Contents	Volume
QP123	A-1	Level 1, 30 ampuls	2.5 ml per ampul
	A-2	Level 2, 30 ampuls	
	A-3	Level 3, 30 ampuls	
	A-123	Level 1, 10 ampuls; Level 2, 10 ampuls Level 3, 10 ampuls	
	B-1	Level 1, 5 ampuls	
	B-2	Level 2, 5 ampuls	
	B-3	Level 3, 5 ampuls	
	C-123	Level 1, 1 ampuls; Level 2, 1 ampuls Level 3, 1 ampuls	

